

NORTHBELT OFFICE CENTER III & IV 107,200 SF

HOUSTON, TEXAS

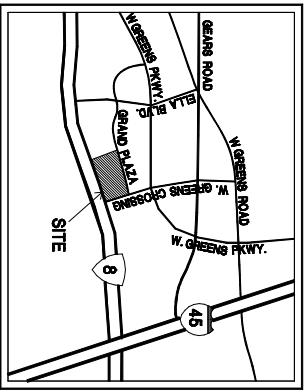

VICINITY MAP
NOT TO SCALE

FEATURES:

- Bldg Area: 107,200 SF
- Site Area: 10,367 Acres
- 16,000 SF To 107,200 SF Available
- Parking Shown: 636 Spaces (6,000 Sp./1000 Rentable SF)
- Landscaped
- Offices To Suit
- 24-Hour HVAC
- Insulated Glass at Exterior Windows
- Exterior Lighting

SITE PLAN

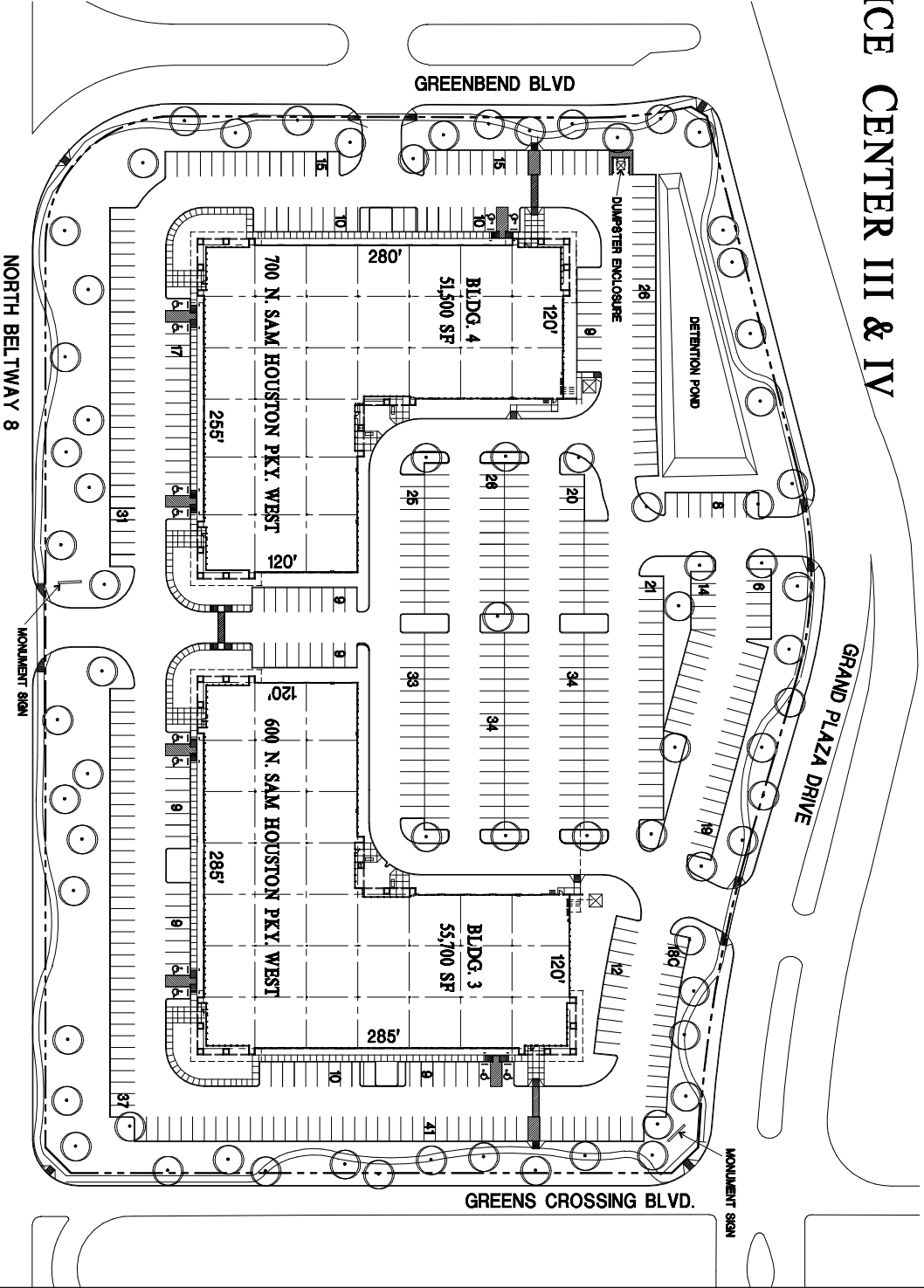

MYERS, CROW & SAVIERS, LTD.

1217 W LOOP NORTH, SUITE 100
HOUSTON, TEXAS 77055

713-465-8600
FAX 713-465-8661